

# Baltimore SSO

## Site Investigation Report

FM Initials: DF

Project: 10 Gwynns Run System Improvements

Site Name:	10_57S	Monitor Series:	4000 WR	Monitor S/N:		Manhole #:		<b>Investigation Information:</b> Upstream Input: (L/S, P/S) DNI Upstream Manhole: Downstream Manhole: Depth of Flow: 6.13" + - .5 Description of Site Hydraulics:
Address / Location:	4515 Umatilla Ave	Map Page #:		Map Grid #:				
		Pipe Height:	17.5"	Pipe Width:	17.5"			
Access:	Drive	IP Address:	CDPD					
Date/Time of Investigation:	2/7/2005 13:50	GPS Coords:	N DD.dddd 39 20.375	W DD.dddd 076 40.255				

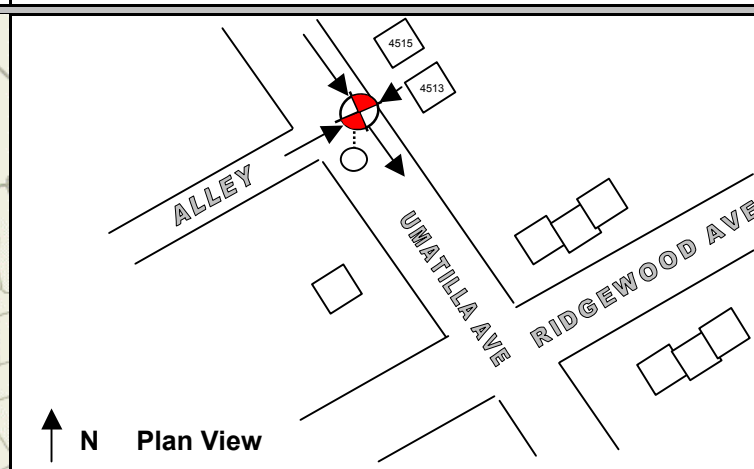
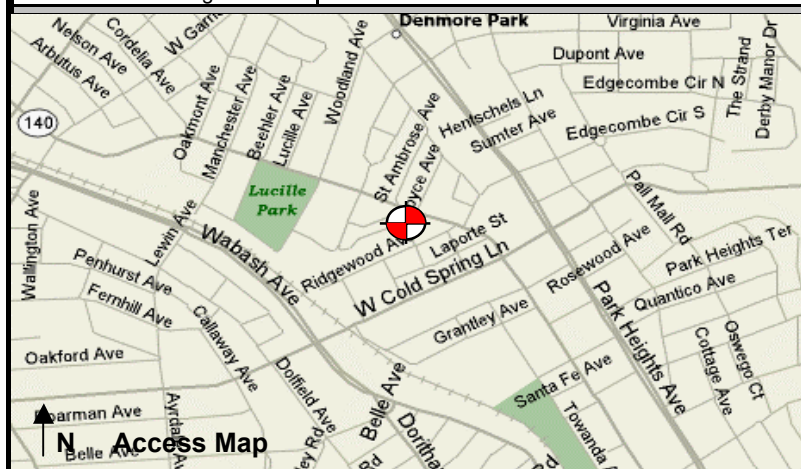
**Manhole Information:**

Manhole Depth: 9.6'

Manhole Material / Condition:  
Coated / Fair

Active Drop Connections?  
No

**System Character:**
☒ Residential  
☐ Commercial  
☐ Industrial

**Notes:** 18-in. Influent & Effluent pipes are lined.

**Legend:**

Cast Iron Flap Valve

Sensor Location

N.T.S.- Not to scale

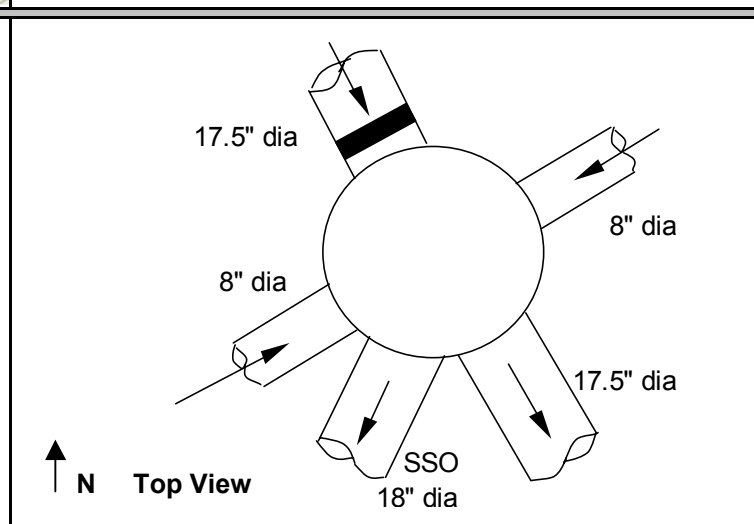
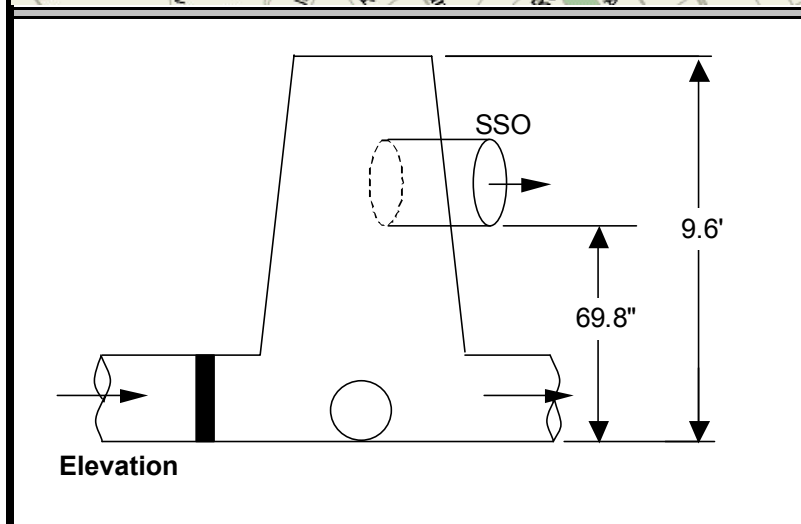

The monitoring period ended as of December 31, 2007.